



A ED0052 17mm Hex Head/ torque wrench	B ED0056	C ED0054 17mm Hex Head/ torque wrench	D ED0062	E ED0308	J ED0055 RHS CABLE
F 8442LT	G ED0059 10mm Spanner	K	NOTE TOP OF CABLES thin Part E inserted on either side of RHS cable Note: direction of Ferrell bend - slides 7 + 9 BOTTOM OF CABLES thin Part E inserted on either side of RHS cable Note: direction of Ferrell bend - slide 11 I 645335 L ED0051		

EZDown Instruction

Hilux RS EZDown - ED0050RS

1
RHS and LHS are determined when sitting in the Drivers side of the Vehicle.
 NB: Locktite all fixing/mounting points where applicable.
 After full fitment remove labels from the cable.

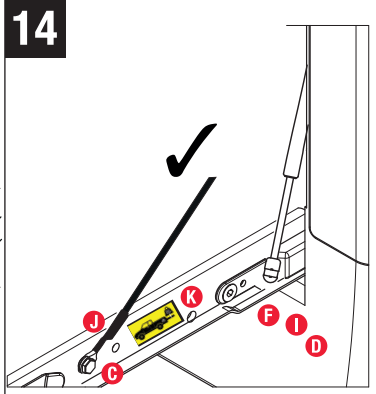
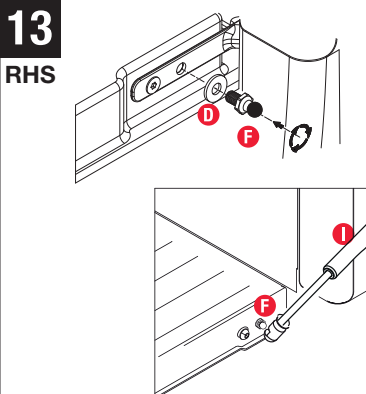
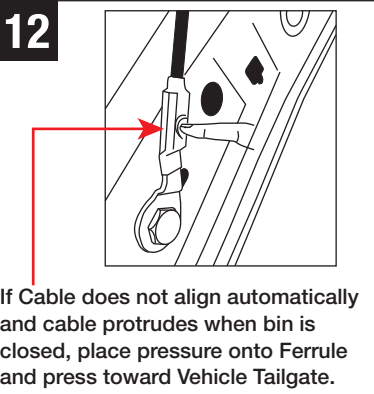
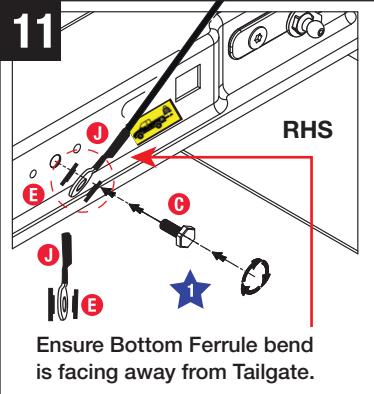
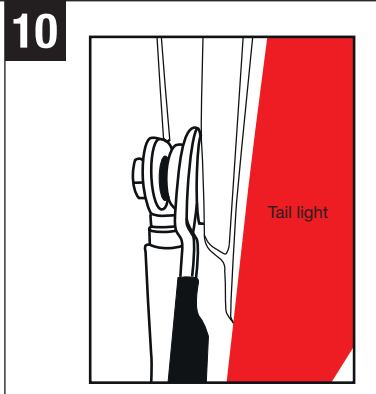
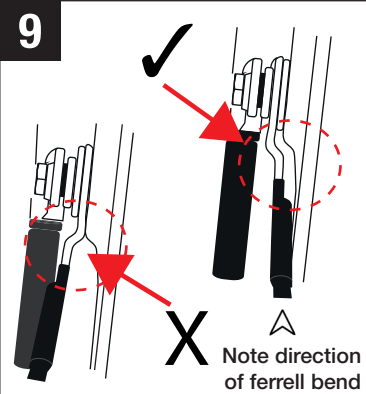
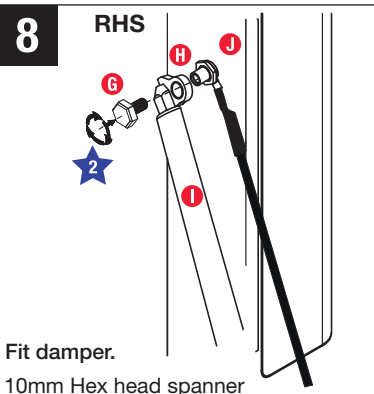
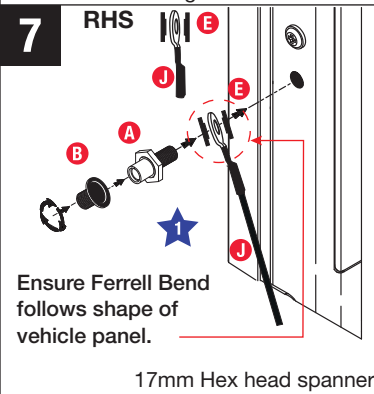
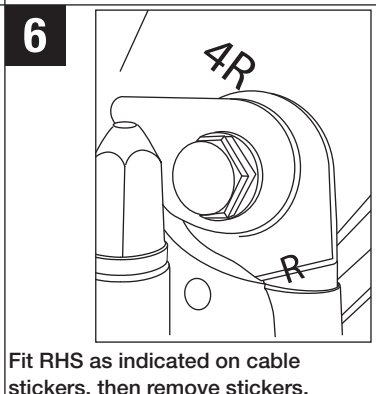
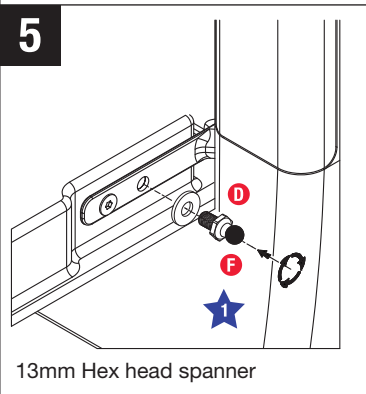
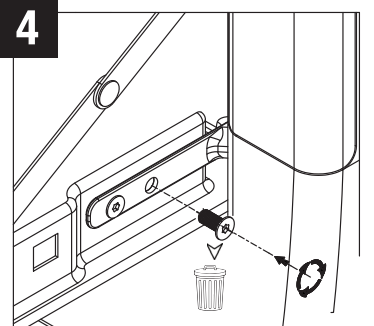
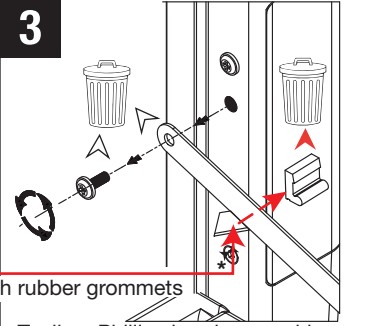
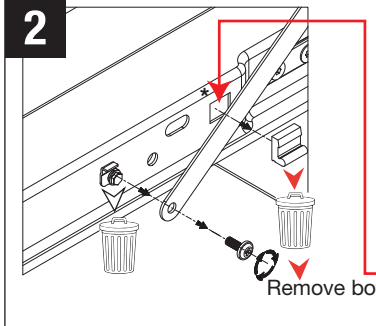

FITTING CODE	MANUFACTURER	MODEL TYPE	YEAR	STOCKIST	PRODUCT	REVISION	LABOUR	DATE	PAGE
ED0050RS	TOYOTA	RS HILUX	2021	GENERAL USE	EZDOWN	2	25min	09/02/2021	1
TORQUE - N.m	★ 27N.m±2N.m			★ 15N.m±2N.m		www.ezdownshop.co.za			

NB: After installation please close tailgate gently to ensure that there is no interference with any hardware.

IMPORTANT:
 No liability will be incurred by Industrial Specialised Applications company, for injury, death, or property damage caused by a product which has been set up, operated, and/or installed contrary to EZDown installation guide/manual, or which has been subjected to misuse, negligence, or accident, or which has been repaired or altered by anyone other than Industrial Specialised Applications, or which has been used in a manner or for a purpose for which the product was not designed.

