



A ED0052 17mm Hex Head/ torque wrench	B ED0056	C ED0054 17mm Hex Head/ torque wrench	D ED0062	E ED0308	J ED0055 RHS CABLE
F 8442LT	G ED0059 10mm Spanner	K	NOTE TOP OF CABLES thin Part E inserted on either side of RHS cable Note: direction of Ferrell bend - slides 7 + 9 BOTTOM OF CABLES thin Part E inserted on either side of RHS cable Note: direction of Ferrell bend - slide 11		
				L ED0051	H 001649

EZDown Reloaded Instruction - 1st Fitment

Hilux RS EZDown Reloaded - RL0050RS

1
RHS and LHS are determined when sitting in the Drivers side of the Vehicle.
NB: Remove rubber grommets as shown slides 2 - 4 and discard
NB: Locktite all fixing/mounting points where applicable.
After full fitment remove labels from the cable.

2

3

4

NB: Remove RHS rubber grommet from side panel as shown

NB: Remove RHS rubber grommet from tailgate as shown

Tooling
Phillips head screw driver No 3

4

Tooling: Phillips head screw driver No 3. If OEM Bolt is very tight apply heat to remove e.g Heat Gun

5

Tooling: Torx Bit T40

6

13mm Hex head spanner

7

Fit RHS as indicated on cable stickers, then remove stickers.

8 RHS

Ensure Ferrell Bend follows shape of vehicle panel.

17mm Hex head spanner

9 RHS

Fit damper.
10mm Hex head spanner

10

X Note direction of ferrell bend

11

Tail light

12

Ensure Bottom Ferrule bend is facing away from Tailgate.

13

If Cable does not align automatically and cable protrudes when bin is closed, place pressure onto Ferrule and press toward vehicle tailgate.
In case cable is too tight against the tailgate slightly pull away from the tailgate and straighten the cable.

14 RHS

15

16
NB HAVE YOU REMOVED YOUR RUBBER GROMMETS - RHS ONLY (2 IN TOTAL) AS INDICATED IN SLIDES 2 - 4?

FITTING CODE	MANUFACTURER	MODEL TYPE	YEAR	STOCKIST	PRODUCT	REVISION	LABOUR	DATE	PAGE
RL0050RS	TOYOTA	RS HILUX	2021	GENERAL USE	EZDOWN RELOADED	3	25min	12/01/2023	1
TORQUE - N.m	★ 27N.m±2N.m			★ 15N.m±2N.m		www.ezdownshop.co.za			

NB: After installation please close tailgate gently to ensure that there is no interference with any hardware.

IMPORTANT:
No liability will be incurred by Industrial Specialised Applications company, for injury, death, or property damage caused by a product which has been set up, operated, and/or installed contrary to EZDown installation guide/manual, or which has been subjected to misuse, negligence, or accident, or which has been repaired or altered by anyone other than Industrial Specialised Applications, or which has been used in a manner or for a purpose for which the product was not designed.



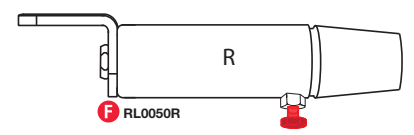
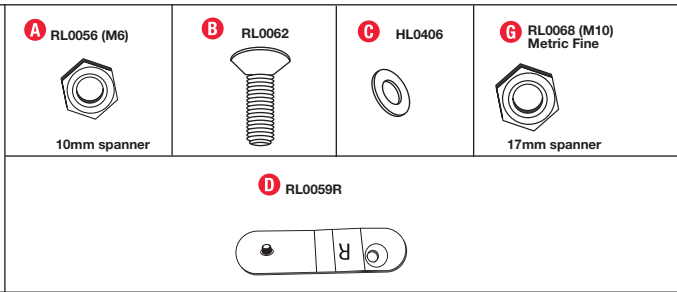

EZDown Reloaded Instruction
- 2nd Fitment

Hilux RS EZDown Reloaded - RL0050RS

1
Right Hand Side (RHS) is determined when sitting in the Drivers side of the Vehicle.

CAUTION:
Do not remove the red bolt from cylinder E until fully installed - if you do you will loose the pre-tention.

2
Open tailgate.
See slide 4 & 5 for area where nut G needs to be fitted.
Loosen Half a Turn before installing fitting Locking Nut shown in Slide 4

3
Remove the two bolts on RHS as indicated.
Once the bolts are removed the taillight will clip from the vehicle body.

4
Taillight cavity

5

At the bottom install the locking nut G supplied onto the existing bolt. See slide 4.
Replace taillight and bolts.

6 RHS
Tailgate

NB: View direction from inside the Vehicle Bin looking towards the Tailgate
Remove the bolt on the bracket and throw away.

7 Tailgate

NB: View from inside vehicle looking out.
Insert bracket and fasten M8 capscrew

8
This kit is only fitted on the RHS

9

RHS - Fit Cylinder in position shown by sliding over end bolt and will lock in this position - see slide 10

10

Cylinder slides over the bolt on the bracket and then over the stud D.
Ensure cylinder locks flush onto the nut.

11

Fix washer and M6 Nut onto stud and fasten when tailgate is still open.

12

REMOVE RED BOLT ON CYLINDER

13 Ensure both Brackets as indicated with * are in alignment.

This is what it will look like on the inside when correctly installed.

14

NOTE:
Tailgate will fall very slowly the first cycle in order for the Reloaded to set.

15

SHOULD YOU WANT TO INCREASE YOUR PRELOAD OR REINSTALL YOUR PRELOAD PLEASE RETURN TO YOUR CLOSEST STOCKIST FOR ASSISTANCE

16

FITTING CODE	MANUFACTURER	MODEL TYPE	YEAR	STOCKIST	PRODUCT	REVISION	LABOUR	DATE	PAGE
RL0050RS	TOYOTA	RS HILUX	2021	GENERAL USE	EZDown RELOADED	1	25min	03/02/2021	1
TORQUE - N.m		★ 27N.m±2N.m		★ 15N.m±2N.m		www.ezdown.co.za			

NB: After installation please close tailgate gently to ensure that there is no interference with any hardware.

IMPORTANT:
No liability will be incurred by Industrial Specialised Applications company, for injury, death, or property damage caused by a product which has been set up, operated, and/or installed contrary to EZDown installation guide/manual, or which has been subjected to misuse, negligence, or accident, or which has been repaired or altered by anyone other than Industrial Specialised Applications, or which has been used in a manner or for a purpose for which the product was not designed.

