

FITMENT INSTRUCTIONS

Alu-Cab™



Fitment of D-Rubber Seal for Canopy Campers

All rights reserved. No part of this document may be reproduced, translated, stored in a retrieval system, or transmitted, in any form or by any means, electronic, mechanical, photocopying, recording or otherwise, without prior written permission of the owner.

Review all instructions information carefully before installation.

Any damages, direct or incidental to the installer and/or property due to incorrect installation of any parts are the responsibility of the installer. Due to the various applications and fitment options available, the responsibility lies with the user to ensure all mounting points are secure and tight before every trip. If unsure, consult with your Distributor regarding the operations of our products.

Users are advised to be mindful of the load they are carrying and drive in accordance with road conditions.

DISCLAIMER

Alu-Cab

Tools, Fasteners & Hardware:

The tables below show the equipment, i.e. tools and fasteners required to start the D-Rubber fitment onto Canopy Camper base unit.

1.1. Tools & Items Required:

TOOLS
Measuring Tape
Pencil & Notepad
Knife / Blade

ITEM
Paint Brush
Sandpaper

1.2. Hardware Required: (Included with Canopy Camper Base Unit)

ITEM	DESCRIPTION	QTY
D-RUBBER	LOADBIN SEAL RUBBER	6 m
SUPER 65 GLUE	SUPER 65 GLUE	150 ml



Figure 1: D-Rubber Kit



WARNING

Always wear appropriate PPE (Personal protection equipment) when fitting this product. Although the mounting kit is designed to be DIY, if you have any doubts or concerns, contact an accredited fitment centre to carry out the work. Alu-Cab will not be liable for any injury to persons, and/or damage to products and/or vehicles.

1. Purpose:

By fitting the D-Rubber during, or shortly prior to, the Canopy Camper to base vehicle fitment, one can accommodate for the varying shape of the vehicle load bin.

This mitigates the issue of having the D-Rubber sitting inside or outside of the load bin lip, forming an ineffective seal.

2. Measuring the Base Vehicle Load Bin Lip:

The vehicle's load bin lip is what interfaces with the lower mounting surface of the Canopy Camper. Due to the fact that the Canopy Camper base unit is universal, and it is only the Mounting and Filler Kits that differ from vehicle to vehicle, it is necessary to attach the D-Rubber in such a way that it matches the shape of the vehicles load bin lip, to ensure a tight and effective seal.

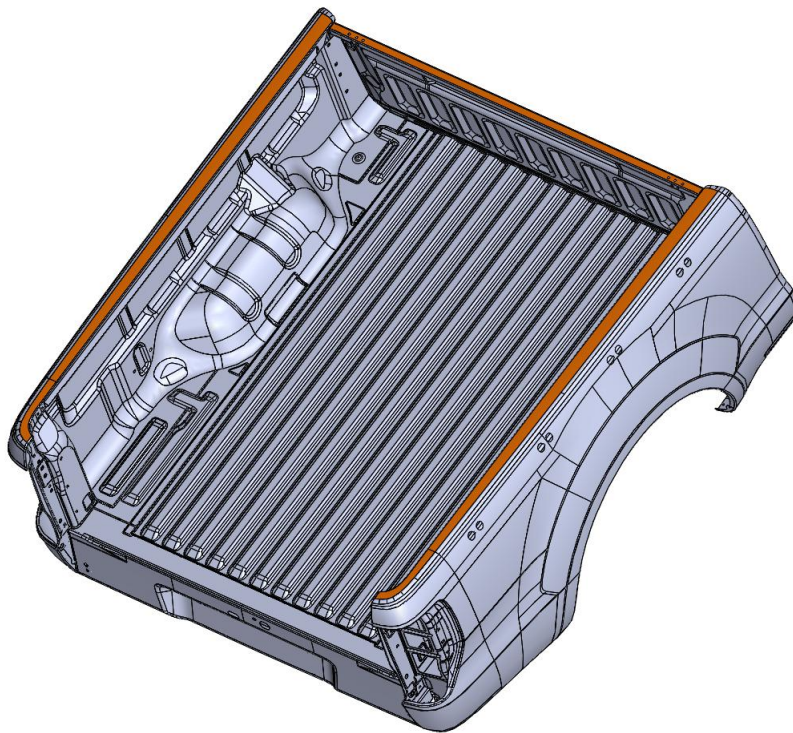

Figure 2: Highlighted Load Bin Lip

When measuring the vehicle's load bin lip, reference Figure 3 below, and take the measurements in the following order (Write them down for reference):

1. Width - Front
2. Width - Rear
3. Length - Overall
4. Divide the Length - Overall by 2, to determine Length - Centre
5. Measure Width - Centre at the determined Length - Centre point.
6. Note the varying lip thicknesses and any unique curves at the corners.

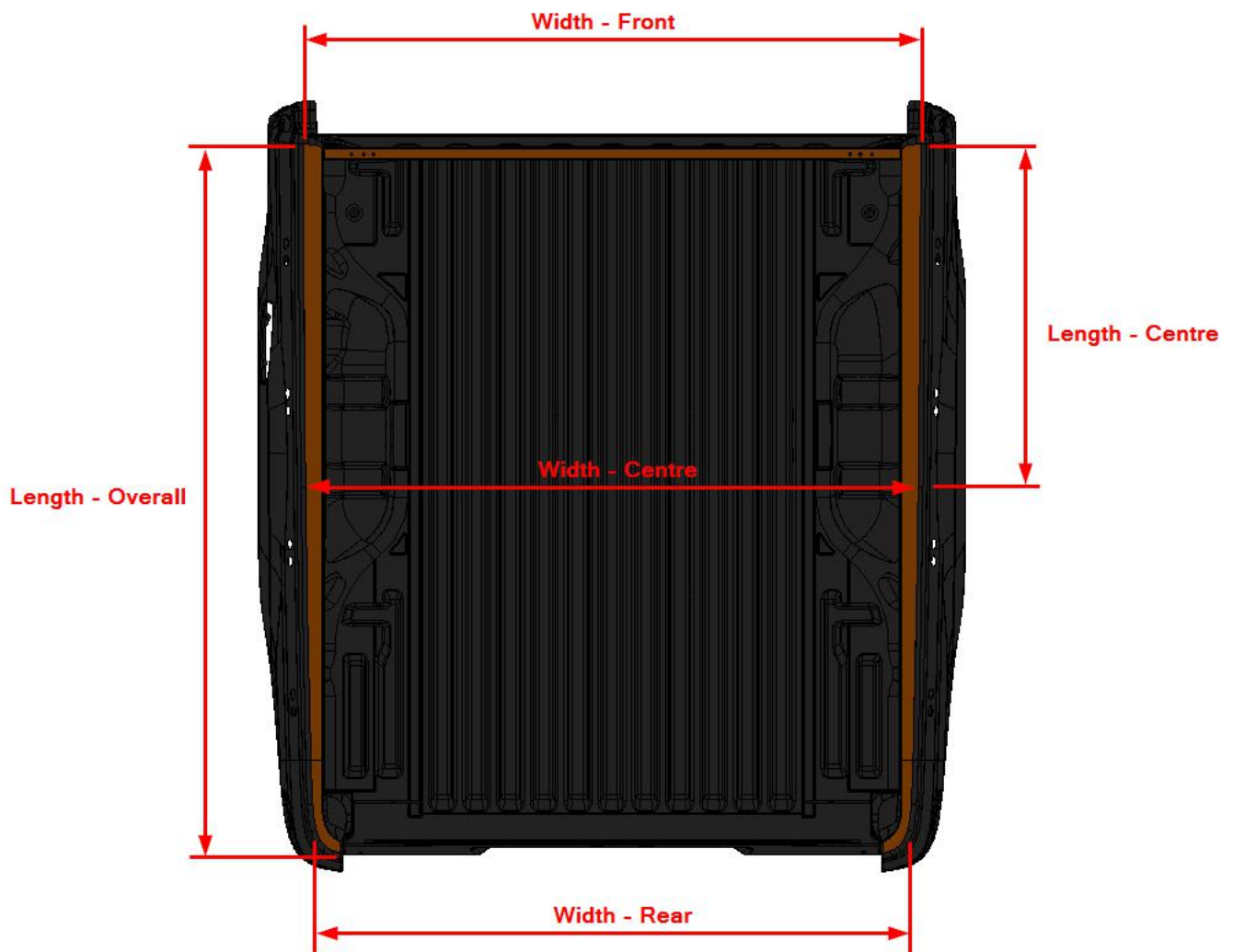

Figure 3: Load Bin Lip Measurement Guide

3. Preparing to attach the D-Rubber to the Canopy Camper:

Firstly, take note of the Canopy Camper base unit dimensions, for the mounting surface, shown in Figure 4 below:

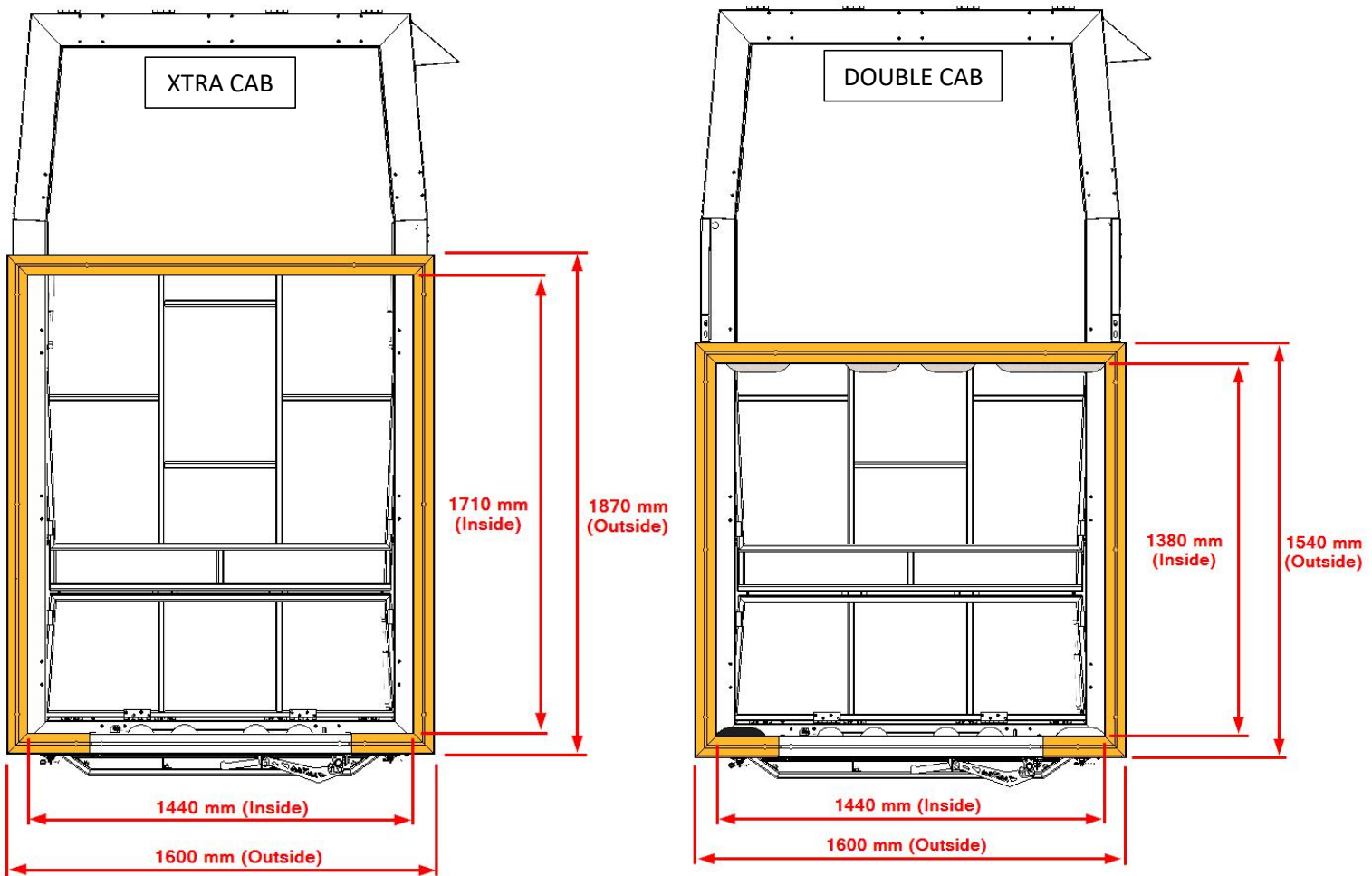

Figure 4: Canopy Camper Base Unit Mounting Surface - Dimensions (Bottom View)

Transfer the measurements taken in *Section 3. Measuring the Base Vehicle Load Bin Lip*, to the mounting surface on the Canopy Camper. Use the front edge of the Canopy Camper Mounting Surface as a reference point, and mark out the five measurements taken from the Load Bin Lip, using a pencil. This will give a clear guideline for how the D-Rubber should be attached to the Canopy Camper mounting surface.

4. Attaching the D-Rubber to the Canopy Camper:

Use sandpaper to lightly rough up a 20 mm band, just within the pencil guideline, on the Canopy Camper's mounting surface. Using a small paintbrush, apply a consistent thin layer of the supplied Super 65 contact adhesive (glue), roughly 20 mm wide, just within the pencil guideline previously marked up.

Allow the glue to 'skin' for approximately 3 - 5 minutes, before attaching the D-Rubber. Press the D-Rubber's flat side against the glue, starting at the door rebate (flush), and working your way around, within the guidelines, applying consistent pressure, ending on the opposite side door rebate. The D-Rubber must be trimmed so that it is flush with the door rebate at the end point. Allow a few minutes before installing the Canopy Camper to the base vehicle. See Figure 5 below:

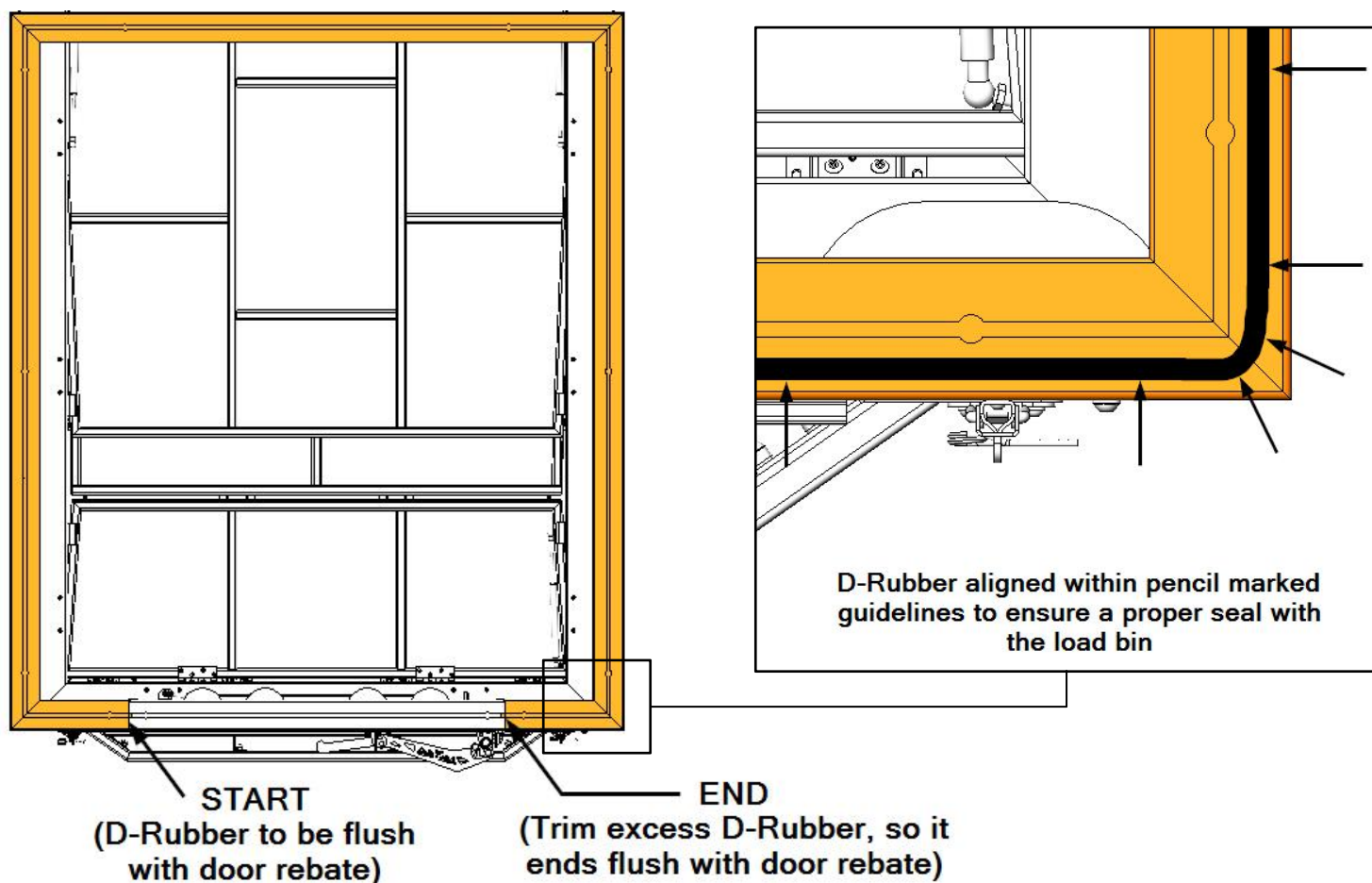

Figure 5: D-Rubber Application Process (Bottom View)